

SLV  
Anjani Heights

LIVE THE GOOD LIFE IN

*Style*

Modern Lifestyle Apartments at Chinautpally, Gannavaram, Vijayawada



# UNLOCK A FABULOUS LIFESTYLE OPPORTUNITY

Vijayawada, the vibrant heart of the country has added a feather to its cap with the upcoming world class capital at Amaravathi. The rapid development of the city is a sign that one will enjoy unprecedented prosperity in the near future.

Come, enjoy a golden future with a sought after address.





# A PANORAMA OF SHEER DELIGHTS

SLV's Anjani Heights which will come up on an elevated part of the city will soon become a magnificent landmark. Anjani Heights will offer a superlative standard of luxury that makes it the destination of choice for a chosen few. Choose your apartment according to your preference of East or West facing and match your taste for gracious living. From futuristic design to breathtaking landscaping, from the extensive list of amenities to the facilities, you will discover that SLV's Anjani Heights is the perfect address for your home.





# UPLIFTING AMBIENCE TO PLEASE THE EYE

Cultivating creativity in every nook and corner, the harmonious plan of Anjani Heights is engaging as well as enlivening. While reflecting freedom of space through thoughtful aspects the apartments exude a modern sense of style.



# PROJECT HIGHLIGHTS

- Central Location in prime neighbourhood
- Premium quality construction
- Earthquake resistant design
- 100% Vaastu compliant
- Spacious two-level car parking facility
- Wide open common areas and driveways
- 24x7 manned and electronic security
- Auto Generator system for uninterrupted power supply
- Automatic water controllers for 24 hours water
- Hi-speed electronic lifts
- Solar fencing
- Solar heat water
- Mobile phone operated gates
- Sensor based modern lighting
- Controlled entry and exit.

North









# UNIQUELY ULTIMATE LIFESTYLE

SLV Anjani Heights is designed to fulfill the family's unique needs. The well-planned architecture brings to life the serenity of gated community living, while offering spacious internal areas and best views of the city. Its warm welcoming facade invites admiring attention from all onlookers.





# MODERN CLUB HOUSE - DELIGHTFUL ENTERTAINMENT & LEISURE OPTIONS

Life is full of pleasant experiences at SLV Anjani Heights. The facilities and amenities present an active lifestyle for its residents. The club house offers plenty of recreation and entertainment options that will engage your mind, body and soul. Keep yourself fit in modern gym and enjoy swimming with your children. Indoor games enclave is a perfect. Where life is full of fun and joy! The modern club house is the perfect venue for socializing. Entertain and experience the good times the club house has to offer.









BLOCK - B

BLOCK - B

North



TYPICAL FLOOR PLAN

TYPICAL FLOOR PLAN



BLOCK - C

North

# INDULGE YOUR SENSES, EXPAND YOUR LIFE

SLV Anjani Heights has been created with the future in mind. There is enough space to accommodate your needs. You have all the freedom to create your own niches and decorate them to your taste. Like Royalty, create your own style and live life to the full.

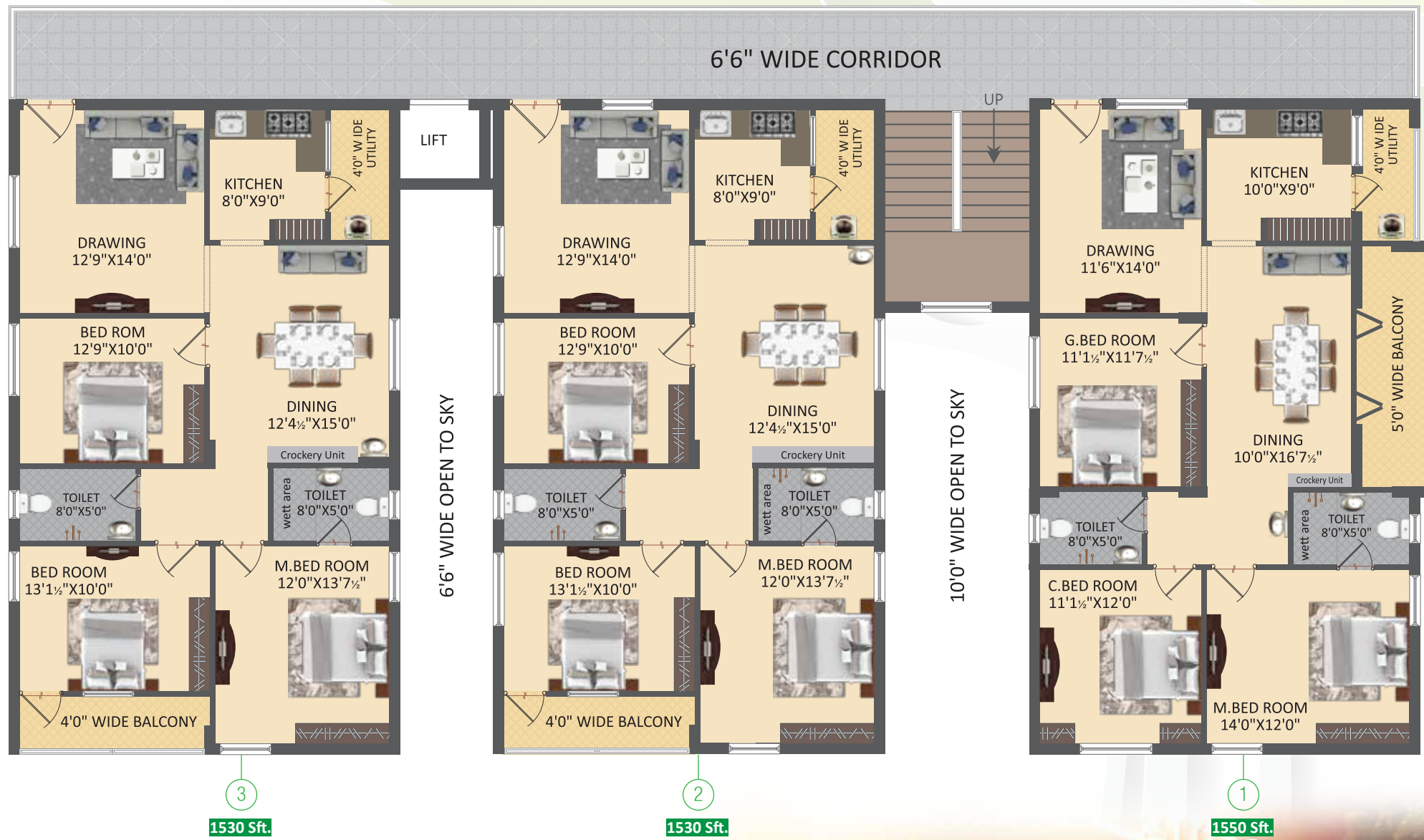

## USP

- Pollution free environment
- Just 700 metres to National Highway & NH By Pass Road
- Supermarkets, Banks, temples close by
- Club House, Swimming Pool, Gym, Walking Track









# SLV - A STAMP OF TOP QUALITY

SLV has successfully completed several residential and commercial projects in Andhra Pradesh and Karnataka. We realize the importance of every step in a project. Right from the procurement of raw materials for construction to the post purchase service, from the amenities we offer to the layout of each of our projects, we consider every step important and enjoy paying attention to the little details. With the help and involvement of our qualified engineers and sales team, a system of checks and balances is established to ensure excellence and consistency.





# TECHNICAL SPECIFICATIONS

## • Structure

RCC framed structure to withstand wind & Seismic loads

## • Super structure

Light weight brick masonry in cement mortar

## • Plastering

Plastering with sponge finish

## • Wood work

Main door: Teak wood frames with hardware of reputed brand

Internal door: Teak wood frames with flush shutter with paint finish & hardware of reputed brand

Windows: uPVC windows and french doors of reputed brand

## • Painting

External: Two coats exterior acrylic emulsion of Asian paint or equivalent brand over one coat of primer

Internal: Smooth wall putty finish with acrylic emulsion of Asian paints or equivalent brand over one coat primer

## • Toilets

> EWC with flush tank of Hindustan/Parryware or equivalent brand

> Hot & Cold water mixer with showers. Provision for geysers in all toilets

> Chrome plated CP fittings Jaguar/Mark/Plumber or equivalent brand

## • Electrical

> Concealed copper wiring of Anchor or equivalent

> Power outlets for air-conditioners in all bedrooms

> Power plugs for cooking range chimneys, refrigerators, microwave ovens and mixer/grinder in kitchen

> Miniature circuit breakers (MCB) for each distribution boards

> Modular switches are of Legrand or equivalent

## • Flooring

Vitrified Tiles: Living, Dining, Bedroom & Kitchen

## • Bathrooms

Acid-resistant, anti-skid ceramic tiles

Bathrooms: Glazed ceramic tiles dado up to 7' ht

Utility/Wash: Glazed ceramic tiles dado up to 3' ht

## • Kitchen

Provision for supply of treated and sweet water connections at one point with provision for fixing of water purifiers, exhaust fan and chimney

## • Intercom connectivity

Telephone points in master bedroom and living areas, intercom facility connecting with the security

## • Plumbing

Concealed best quality PVC / CPVC / uPVC pipes

## • Cable TV

Provision for cable tv connection in living room and master bedroom

## • Lifts

High speed automatic passenger lifts with rescue device room

## • Generator

D. G. set back-up with acoustic enclosure & AMF for common areas, lifts, pumps, essential areas and selected points in each flat 800 watts



# LOCATION MAP

Rapidly Developing Location at Chinautpally, Gannavaram. Just 10 minutes away from good schools, hospitals and shopping centers.

You are at the centre of your world with easy access to schools, colleges, shopping, airport, railway station, bus station, hospitals, parks and recreation.



- Central Location at Chinautpally, Gannavaram
- Close to Pinnamaneni Siddhartha Medical College
- 700 metres from National Highway, Outer Ring Road
- 500 metres to Bus Stop
- 4 kms to International Airport



# AMENITIES

- Exclusive club house
- Swimming pool with kids pool & changing rooms
- Gymnasium
- Indoor games
- Multipurpose hall
- Super market
- Library
- Yoga & Meditation hall
- Cafeteria
- Visitors lounge
- Children play area
- Open party lawn with stage
- Open meditation area with central tree
- Excellent landscaping & lawns
- Play courts



Not just a location... A dream fulfilled...

SLV Anjani Heights is a creation, made by the people who cater to the need to improving standards of living. As the image of Andhra Pradesh's capital Vijayawada undergoes a dynamic revolution, SLV Infra strives to enhance the quality of living by offering never-before facilities, amenities and living spaces.

SLV Anjani Heights fulfills the aspirations of customers who wish to make this location their home.

## Upcoming



SLV 99 GBS TOWERS - BHIMAVARAM

## Ongoing



SLV ARCADE - BHIMAVARAM



SLV ARCADE PARTY LAWN - BHIMAVARAM



SLV SYAM ENCLAVE

## Completed



SLV YAMUNOTRI TOWERS



SLV GANGOTRI TOWERS



SRI RAGAVENDRA TOWERS



SLV GOKUL HOMES



SLV ASR TOWERS



PRASHANTHI NAGAR



SLV TOWERS I



SLV TOWERS II



SLV MYTHRI TOWERS

# PROJECTS





SLV  
Anjani Heights

Developers:

**SLV Infra**

Near Pinnamaneni Siddhartha Medical College, Chinoutpally

Gannavaram, Vijayawada - 521286

P: +91 800 880 2244, 94911 42225

E: slv.bvrm@gmail.com

Architects:



H.No. 2 - 50/2, White Fort, Opp. Meenakshi Sky Lounge

Hitex Road, Madhapur, Hyderabad - 500 081

M: +91 81869 66333, 040 2311 3366

E: siddhucons@gmail.com W: www.siddharthconsultants.com

Note: This brochure is only a conceptual presentation of the project and not a legal offering. The promoters / developers reserve right to alter and make changes in elevation, specifications and plans as deemed fit.